

GRILLES AND FRAME FOR CLIMACONVECTORS type CVK2, CVK4, CVKS

GRILLES

ROLL-UP WOODEN GRILLE

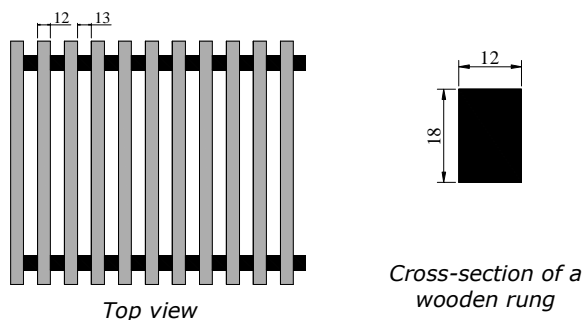

The grille is made of natural wood.

Standard:

Spacings (sleeves) between the rungs are made of black PVC.

Option:

Spacings (sleeves) are also available in colors:

- gray WG-15
- beige W8-29
- light brown RAL 8256
- dark brown RAL 8352

Wooden spacing (beech unvarnished, L = 17 mm)

The maximum length of one grille section is 6000 mm.

The grille is only available in a roll-up version.

Type of the grille	Name of the grille	Order code
Roll-up wooden grille	Roll-up oak grille	ZD-1,8/W/L
	Roll-up ash grille	ZJ-1,8/W/L
	Roll-up beech grille	ZB-1,8/W/L
	Roll-up merbau grille	ZM-1,8/W/L
	Roll-up jatoba grille	ZJB-1,8/W/L

GRILLE CORNER SO. HERRINGBONE

Grille corner so. herringbone ash sleeve beech

ROLL-UP ALUMINIUM GRILLE

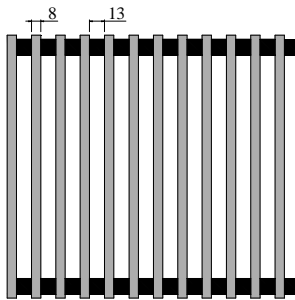

Top view

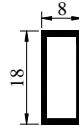

Cross-section of aluminium grille - profile closed

The grille is made of aluminium - profile closed.

The grille options:

- natural aluminium
- anodized aluminium
- aluminium - wood imitation (profile closed only)

Standard:

Spacings (sleeves) between rungs as a standard are made of black PVC.

Option:

Spacings (sleeves) are also available in colors:

- gray WG-15
- beige W8-29
- light brown RAL 8256
- dark brown RAL 8352

Type of the grille	Name of the grille	Order code
Roll-up aluminium grille - profile closed	Roll-up natural aluminium grille – profile closed	ZAL-1,8/W/L
	Roll-up anodized aluminium grille – profile closed	ZAAL-1,8/W/L
	Roll-up wood imitation aluminium grille – profile closed	ZIAL-1,8/W/L

LINEAR ALUMINIUM GRILLE

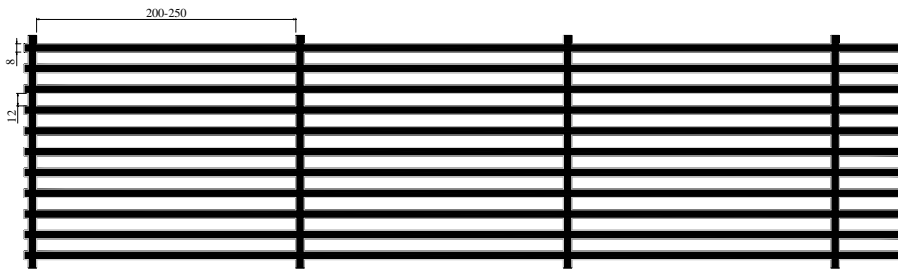

Top view

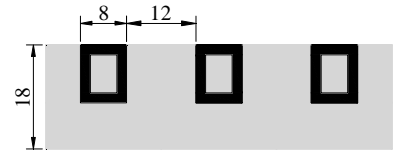

Cross-section of linear grille
painted in RAL

The grille is made of aluminium – profile closed.

The grill is made in total of aluminium.

The grille options:

- Natural aluminium - spacings (sleeves) are made of aluminium painted in black color RAL 2005
- Anodized aluminium - spacings (sleeves) are made of aluminium painted in black color RAL 2005
- Aluminium painted in RAL

MODULAR ALUMINIUM GRILLE

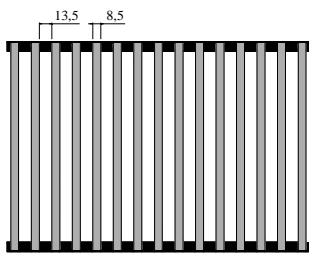

Top view



Cross-section of modular aluminium
grille

The grille is made of aluminium.

The grille options:

- natural aluminium
- anodized aluminium

Spacings (rung fasteners) are made of black plastic.

The length of single module is 440 mm.

Type of the grille	Name of the grille	Order code
Modular aluminium grille – profile closed	Modular natural aluminium grille – profile closed	MAL-1,8/W/L
	Modular anodized aluminium grille – profile closed	MAAL-1,8/W/L

LINEAR STAINLESS STEEL GRILLE

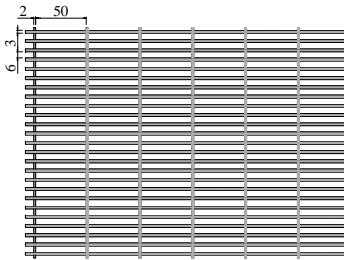

Top view

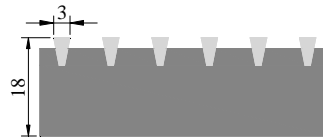

Cross-section of stainless steel grille

The grille is available only as a rigid version.

The maximum length of one section of the grille is 2000 mm.

Grille length longer than 2000mm are made of several elements of equal lengths.

Type of the grille	Name of the grille	Order code
Stainless steel grille	Linear stainless steel grille	SN-1,8/W/L

WOODEN GRILLE



WOOD IMITATION ALUMINIUM GRILLE



ANODIZED ALUMINIUM GRILLE

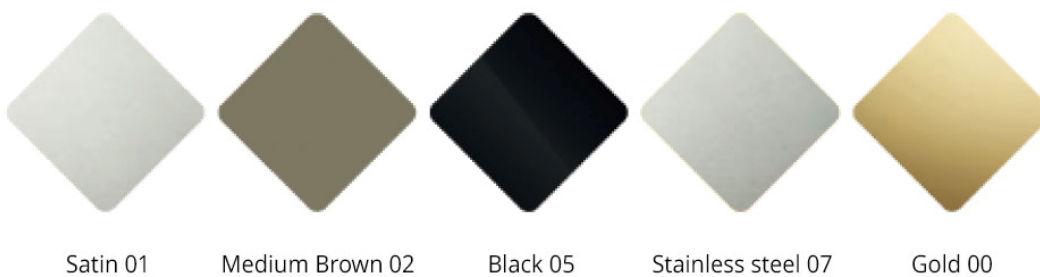

FRAME

FRAME DETAILS

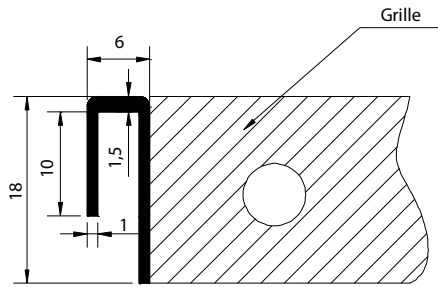

Frame type L

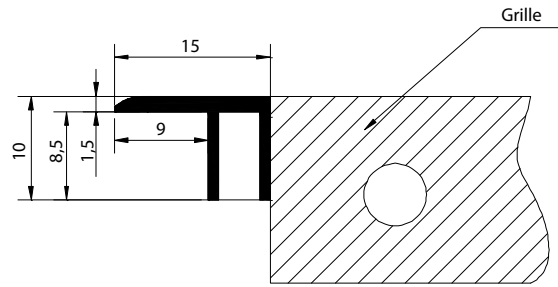

Frame type F

FRAME ASSEMBLY INSTRUCTION

Aluminium frame type L is a decorative element, and type F apart of the decorative function is also as a masking element which can cover the space between the floor and the duct of the trench heater.

The frame F is supplied as a cut off elements for self-assembly. Assembly of the frame type F must be done by using a silicone glue. The manufacturer is not liable for problems associated with frame assembling for trench casing deformation caused by the improper installation of the heater.

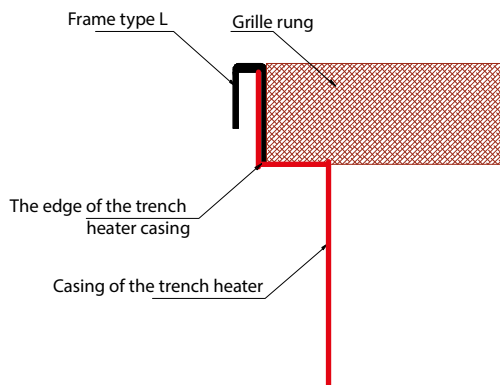

Frame type L

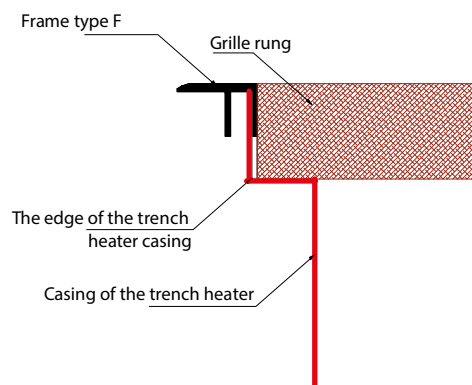

Frame type F